

LAGUNA LAKES EXTERIOR BERM AND SWALE GUIDELINES

The berm and swale behind your home is owned by and maintained by the Laguna Lakes CDD as a vital piece of the community security and stormwater management system. The health and stability, as well as the appearance of the berm is managed for the benefit of the Laguna Lakes community.

The berm and swale areas are located around the interior and exterior sides of the perimeter walls and fences. This includes the area between the security wall and 9' to 15' into residential backyards depending on your location. The attached exhibit illustrates the approximate distance from the wall and into backyards. A more accurate view of this landscape buffer and drainage easement may be shown on your property survey.

During a storm event, the swale area conveys stormwater into drainage structures and the lakes, and it is important that this area is not blocked so that the system operates as designed. The berm area includes a security wall and plantings maintained by the Laguna Lakes CDD. The Laguna Lakes CDD periodically trims and maintains the plantings located within this area.

The Laguna Lakes CDD would like to remind residents that they are not allowed to place items or install additional vegetation within the berm or swale areas as they may interfere with maintenance, affect plantings, or block the flow of stormwater.

Items that are not allowed to be placed by residents into the berm or swale areas include (but not limited to):

- Plants
- Vegetation debris or other discarded items
- Decorative items
- Birdfeeders
- Lights
- Outdoor toys
- Outdoor equipment and tools

If you are in doubt about planting or possibly installing any item in the berm and swale area, please contact the CDD. In all cases when planning or installing a pool, please contact the CDD as noted below.

The Laguna Lakes CDD thanks you for your cooperation with this matter and for helping to keep Laguna Lakes a beautiful community. If you have any questions about these guidelines, please reach out to District Manager Cal Teague at cteague@cddmanagement.com or Field Manager Chris Pepin at cpepin@cddmanagement.com.

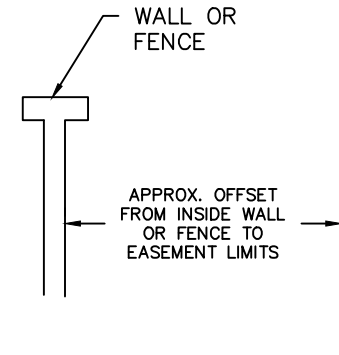
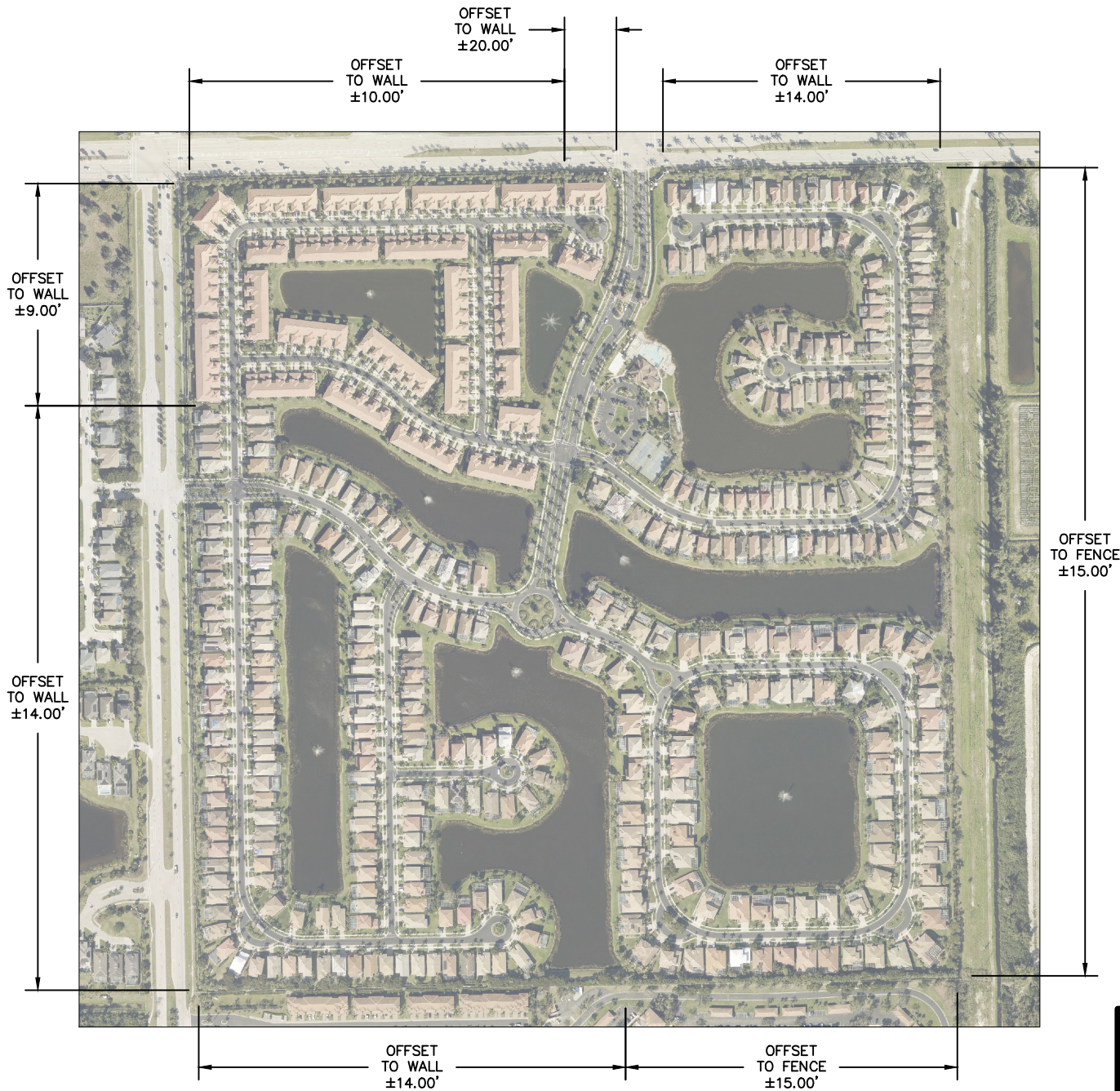

LAGUNA LAKES CDD
 LANDSCAPE MAINTENANCE
 EASEMENT

Bowman Consulting Group, Ltd.
 6200 Whiskey Creek Drive
 Fort Myers, FL 33919
 Phone (239) 985-1200
 www.bowmanconsulting.com
 © Bowman Consulting Group, Ltd.

Bowman
 FLORIDA CERTIFICATE OF AUTHORIZATION NUMBER 30462